

hk 165 L4

Kg.	33480	21310	16000	12540	10110	8235	6810
mt.	4.66	7.10	9.20	11.40	13.70	16.24	18.88

hk 165 L4+S3

Kg.	7130	6020	5200	4490	3830	3260
mt.	16.56	18.64	20.54	22.54	24.76	27.08

hk 165 L4+S4

Kg.	7020	5850	5040	4340	3720	3155	2650
mt.	16.56	18.76	20.66	22.66	24.76	27.08	29.50

hk 165 L4+L3

Kg.	6590	5290	4360	3590	2910	2350
mt.	17.16	19.84	22.34	24.94	27.76	30.68

hk 165 L4+L4

Kg.	6480	5130	4210	3450	2810	2240	1760
mt.	17.16	19.96	22.46	25.06	27.76	30.68	33.70

hk 165 L5

Kg.	33210	20720	15550	12150	9760	7990	6560	5450
mt.	4.66	7.20	9.30	11.50	13.80	16.20	18.84	21.58

hk 165 L5+S3

Kg.	5560	4710	4070	3490	2960	2490
mt.	19.06	21.14	23.04	25.04	27.26	29.56

hk 165 L5+S4

Kg.	5450	4550	3920	3350	2850	2375	1950
mt.	19.06	21.26	23.16	25.16	27.26	29.58	32.00

hk 165 LK5+L3

Kg.	5100	4090	3350	2720	2160	1680
mt.	19.66	22.34	24.84	27.44	30.26	33.18

hk 165 L5+L4

Kg.	4990	3950	3210	2590	2050	1570	1160
mt.	19.66	22.46	24.96	27.56	30.26	33.18	36.20

hk 165 L6

Kg.	33000	20040	15060	11760	9420	7690	6350	5230	4340
mt.	4.66	7.35	9.45	11.65	13.95	16.35	18.85	21.61	24.47

hk 165 L6+S3

Kg.	4290	3630	3120	2650	2210	1810
mt.	21.72	23.80	25.70	27.70	29.92	32.24

hk 165 L6+S4

Kg.	4180	3480	2970	2510	2100	1700	1300
mt.	21.72	23.92	25.82	27.82	29.92	32.24	34.66

hk 165 L6+L3

Kg.	3890	3100	2500	1990	1510	1100
mt.	22.32	25.00	27.50	30.01	32.92	35.84

hk 165 L6+L4

Kg.	3780	2960	2360	1850	1400	1000	640
mt.	22.32	25.12	27.62	30.22	32.92	35.84	38.86

hk 165 L7

Kg.	32850	19590	14720	11490	9190	7480	6150	5100	4210	3480
mt.	4.66	7.45	9.55	11.75	14.05	16.45	18.95	21.55	24.39	27.33

hk 165 L8

Kg.	32750	19080	14410	11250	8990	7300	6000	4960	4120	3390	2780
mt.	4.66	7.59	9.67	11.87	14.17	16.57	19.07	21.67	24.37	27.31	30.35

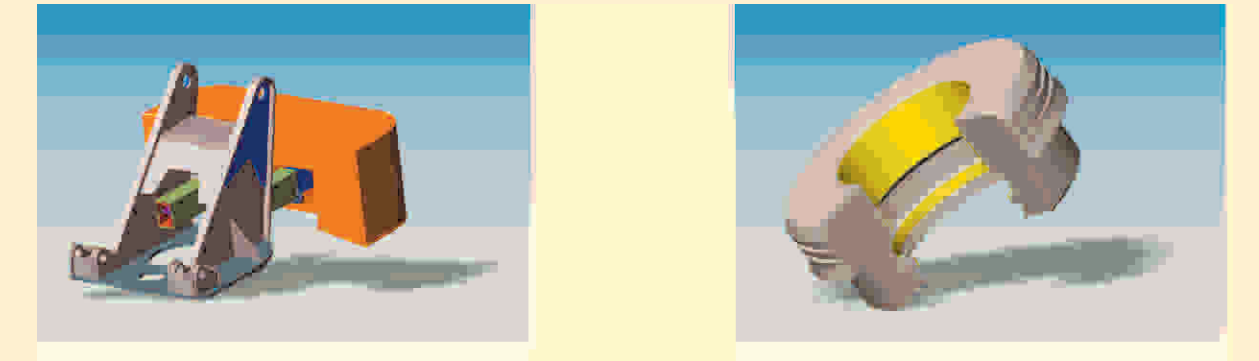

Katalogdaki fotoğraflar HİDROKON LTD.ŞTİ. nin izni olmadan kopyalanamaz.
The photographs in catalogue can't be copied without the permission of HİDROKON LTD. ŞTİ.

STANDART



Dönüş Açısı
Slewing Angle



Koltuk
Seat



Hidrolik Yağ Tankı
Oil Tank

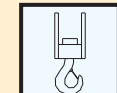

Kanca
Hook

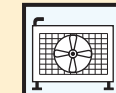

Yağ Soğutucusu
Oil Cooler

OPSİYONEL

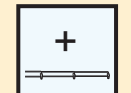

İlave Mekanik Bom
Mechanic Extensions



İnsan Sepeti
Basket

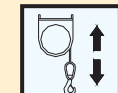

Halat Tamburu
Winch



Uzaktan Kumanda
Remote Control

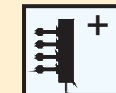

İlave Kumanda Dilimi
Additional Function

STANDARD

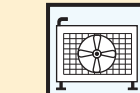

Yağ Soğutucusu
Oil Cooler

OPTIONAL



İlave Kumanda Dilimi
Additional Function

Teknik bilgiler yol gösterici olup, bağlayıcı değildir. Ölçüleri, özellikleri değiştirme ve geliştirme hakkımız saklıdır.
Technical specialty is guider but not connective. Our changing right about size and feature is secret.

		hk 165 L4	hk 165 L5	hk 165 L6	hk 165 L7	hk 165 L8
Max. Kaldırma Momenti - Max. Lifting Moment	(Tm)	165	165	165	165	165
Max. Kaldırma Kapasitesi (3m. radüste) - Max. Lifting Capacity (at 3m. radius)	(Ton)	55	55	55	55	55
Hidrolik Bom Sayısı - Number of Hydraulic Boom	(Adet)	4	5	6	7	8
Max. Hidrolik Uzanma Mesafesi - Max. Hydraulic Reach	(m)	13.70	16.20	18.85	21.55	24.37
Max. Mekanik Uzanma Mesafesi - Max. Manuel Reach	(m)	18.88	21.58	24.47	27.33	30.35
Max. Dönüş Açısı - Max. Slewing Angle	(°)	Sonsuz (Continuous)	Sonsuz (Continuous)	Sonsuz (Continuous)	Sonsuz (Continuous)	Sonsuz (Continuous)
Vinç Şasi Yüksekliği - Crane Chassis Height	(mm)	320	320	320	320	320
Max. Çalışma Basıncı - Max. Working Pressure	(Bar)	250	250	250	250	250
Yağ Tankı Kapasitesi - Oil Tank Capacity	(lt)	516	545	570	600	625
Max. Çalışma Açısı- Max. Working Angle	(°)	85	85	85	85	85
A	(mm)	5110	5210	5350	5490	5630
B	(mm)	5545	5645	5785	5925	6065
C	(mm)	8013	8113	8253	8293	8533